

KEY INFORMATION FOR KEY WORKERS PARENTS/CARERS

Week beginning 1st June

MAP

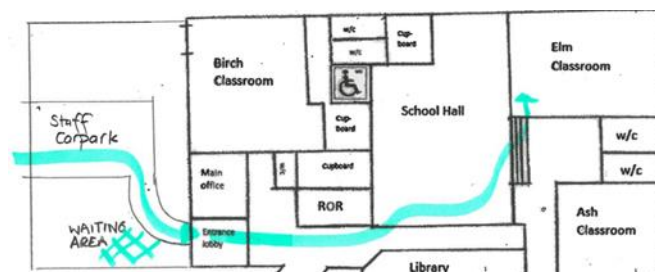

Children to walk into school through Staff carpark entrance and through the main entrance. Please leave/drop at the gate unless coming to breakfast or after school club. When coming into the foyer please use the hand sanitiser before ringing the bell.

BRING TO SCHOOL	TIMINGS	REMINDERS								
<ul style="list-style-type: none"> ✓ Lunch (or ordered one from fresh-start) ✓ Fruit (if required) in a sandwich bag ✓ Hat (if needed) ✓ Raincoat (if needed) <p>Any prescribed medication to be given to the office as normal please.</p>	<table border="1"> <tr> <td>Drop-off time</td> <td>8:30am</td> </tr> <tr> <td>Pick-up time</td> <td>3:20pm</td> </tr> <tr> <td>Pick-up time (Friday)</td> <td>1:20pm</td> </tr> <tr> <td>Location</td> <td>Staff Carpark-Front Entrance</td> </tr> </table>	Drop-off time	8:30am	Pick-up time	3:20pm	Pick-up time (Friday)	1:20pm	Location	Staff Carpark-Front Entrance	<ul style="list-style-type: none"> • If you need to speak to the office, Mr Smith or Miss Hirst we do ask that if possible you ring or email to minimise contact but do understand that this isn't always possible. If you need to come to the office, please use the tape markings which will be marked 2m apart to socially distance appropriately. • When dropping off the children please do not bring them into classroom doors but again there will be a 2m spot away from which we kindly ask you stand to see them in. We advise just one parent dropping off. • We also request that as parents you do not congregate in the grounds but deliver/pick up your child. When waiting at the end of the day to collect we ask you stand a sensible distance apart from other parents and carers. • Due to the multiple entrance points we are unable to store scooters and bikes at this time.
Drop-off time	8:30am									
Pick-up time	3:20pm									
Pick-up time (Friday)	1:20pm									
Location	Staff Carpark-Front Entrance									
<p>PLEASE DON'T BRING TO SCHOOL</p> <ul style="list-style-type: none"> • Book bags • PE kits • Toys • Reading books (We will be unable to swap these currently but will read with the children in school) • Please put suntan lotion on before coming to school. 	<p>UNIFORM</p> <p>School uniform worn by all where possible although leniency will be given if items have been outgrown. (Plain alternatives please)</p> <p>Trainers needed to be worn to school on Wednesdays</p>									
<p style="text-align: center;">HYGIENE</p>		<ul style="list-style-type: none"> • If your child is ill <u>in anyway</u> then please do not send them in to school. • If a child or staff member develops symptoms compatible with coronavirus, they will be sent home and advised to self-isolate for 7 days. Their fellow household members should self-isolate for 14 days. All children and staff in that bubble will be at this point sent home. • Where the child or staff member tests negative, they and everyone else can return to their bubble and the fellow household members can end their self-isolation • If staffing levels become low due to illness we may need to shut the bubble, but we will endeavour to give you as much notice as possible. See information letter sent on 21st May for more details. 								
<ul style="list-style-type: none"> ▪ Practise good handwashing at home – 20 seconds ▪ Remind children of the catch it, bin it, kill it slogan ▪ Remind children to wash hands after coughing or sneezing. 										